

TP400-D6 turboprop engine

The innovative power

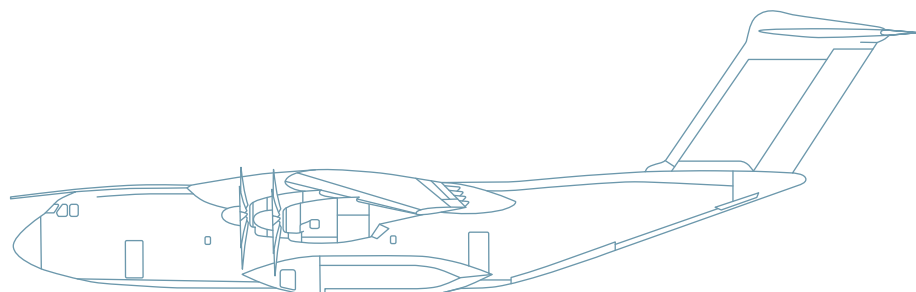

TP400-D6 – technology features

The TP400-D6 is being developed and produced by EPI Europrop International GmbH, a joint venture formed by Industria de Turbo Propulsores (Spain), MTU Aero Engines GmbH (Germany), Rolls-Royce (UK), and Snecma (SAFRAN Group, France).

The TP400-D6 is designed to meet the operational requirements of the A400M military transport aircraft, Europe's response to the increasing need for military transport capacity as well as peacekeeping and humanitarian missions around the world.

To fulfill the unique requirements of the A400M, the TP400-D6 features advanced aerodynamic and component design, low fuel burn and weight, efficiency over a wide operating range from extended low-level flights to high-speed cruise, and integrated engine and propeller control.

For the TP400-D6, MTU develops and produces the intermediate-pressure compressor, turbine and shaft, the engine protection and monitoring unit (EPMU) as well as the engine control software.



Most powerful Western turboprop:

- Designed for high-speed cruise
- Ample growth potential
- Low-risk design
- Low life-cycle cost
- Modular design

Variable stator vane actuator (for HPC)

Engine control software

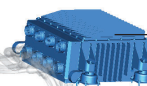

Engine protection and monitoring unit (EPMU)

Intermediate-pressure turbine

Intermediate-pressure shaft

Fuel-cooled oil cooler (FCOC)

Intermediate-pressure compressor



MTU Aero Engines GmbH
Dachauer Straße 665
80995 Munich • Germany
Tel. +49 89 1489-0
Fax +49 89 1489-5500
info@mtu.de
www.mtu.de

TP400-D6 engine specifications

Type of engine	three-shaft turboprop
Power output	approx. 11,000 shp at sea level
SFC	optimized for various missions
Max. propeller speed	860 rpm
Pressure/compression ratio	25
Weight	approx. 1,860 kg
Overall length	3,500 mm
Propeller	Ratier-Figeac FH386 propeller